

# Simplex Baseboards

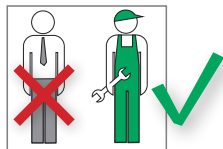

These instructions are intended for work on heating systems which must only be undertaken by qualified professional personnel and in accordance with the respective applicable regulations, guidelines and rules of engineering.





## 1. Preparing the baseboard for assembly and installation

- Remove the baseboard from the packaging and cut it to length with consideration for the dimension sketches **1** and **2**. Mitred cuts are not necessary!
- It is recommended that additional mounting brackets are installed at 10 cm intervals near corners and edges.
- **Baseboard T:**  
Securely fix the prepared carpet strips (width approx. 82 - 85 cm) by removing the protective film on the adhesive surface. **3**
- Prepare the baseboard with notching pliers in the area of heating radiator connections according to the specifications. **4**  
Notch out to approx. under the groove on the under side of the board.
- Notch out two openings of 3 x 3 cm dimension when installing with the **SL-MULTI** connection kit.

**1** Outer corner - 3 mm, flush profile

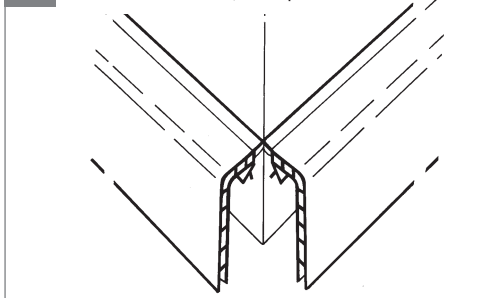

**2** Inner corner

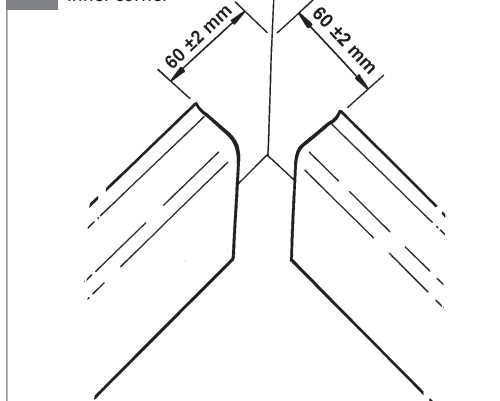

**3**

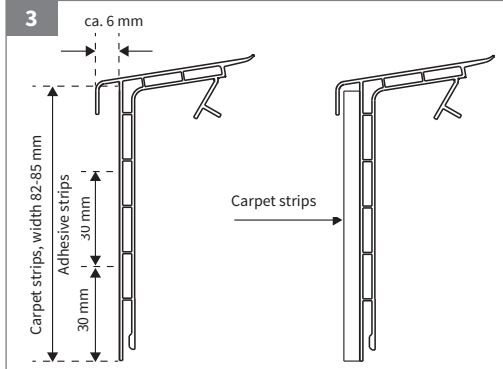

**4**

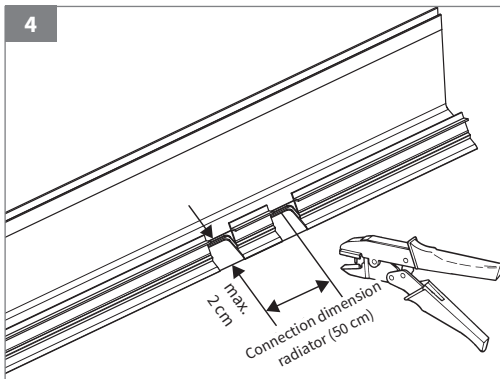



## 2. Assembling the moulding

The butt joint connector and end caps will be inserted directly in the profile without assembly clips. Mounting brackets must be installed on both sides in the area of the moulding.

The spacing interval should not exceed 10 cm.

- Insert mounting clips on both ends of the profile. **5**
- Attach the moulding e.g. outer corner approx. 2 cm above the floor. **5**
- Press the moulding e.g. outer corner against the wall and push it downwards. **7**

5

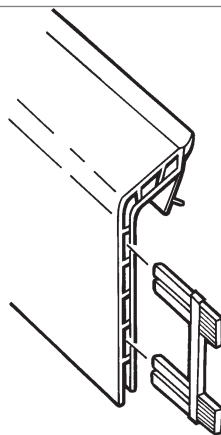

6

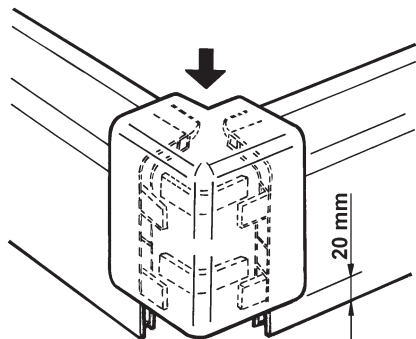

7

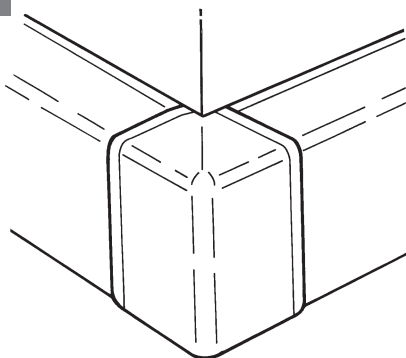

## 3. Baseboard with cable channel

Cable channel with additional separation web for dividing electrical and/or low voltage cables. The cable channel will be clipped simply into the mounting brackets.

8

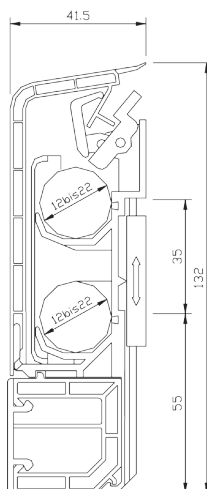

The illustrations are symbolic and may differ from the respective product. Errors and technical changes reserved.