

Pegler Valve

Cast iron butterfly valve

V907 Butterfly valve



General Information

Size	Pattern No.	Pack 1 Qty	Pack 2 Qty	Code	Barcode	Price (£) each ex VAT
65mm	V907	1	0	15332	5022050555441	£497.68
80mm	V907	1	0	15333	5022050555458	£638.16
100mm	V907	1	0	15334	5022050555465	£893.53
125mm	V907	1	0	15335	5022050555472	£1172.36
150mm	V907	1	0	15336	5022050555489	£1272.03
200mm	V907	1	0	15337	5022050555496	£2017.87

V907 Butterfly valve

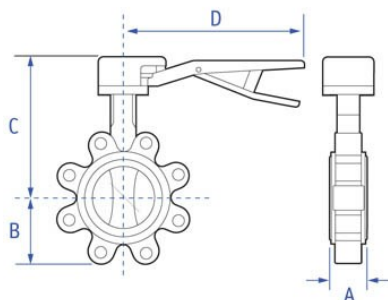

Dimensions

Code	Description	A	B	C	D
15332	65mm V907	46	70	181	200 5.00
15333	80mm V907	46	89	187	200 5.50
15334	100mm V907	52	106	211	290 8.40
15335	125mm V907	56	120	226	290 9.80
15336	150mm V907	56	132	239	290 11.80
15337	200mm V907	60	164	293	450 23.00

Pegler Yorkshire reserve the right to change specifications

Guarantee

Pegler 5 Year Guarantee - Terms and Conditions

Products are subject to a 5 year guarantee that is between Pegler and the final purchaser of the product.

The guarantee is subject to proof of purchase being supplied.

This guarantee does not affect any statutory rights the consumer may have in law.

The guarantee covers manufacturing or material defects when installed in accordance with our instructions on specified tube materials and applications, and does not cover parts subject to normal wear and tear.

This product range has been designed for the use of homeowners, domestic and commercial applications and therefore the Guarantee is subject to the product being properly selected for their intended service conditions.

The guarantee is not applicable where the product is fitted contrary to the conditions in the fitting instructions.

This is reinforced where valves are covered by the European Pressure Equipment Directive (PED97/23/EC) where Installation, Operating and Maintenance Instructions are supplied with each product and/or carton.

Provided it is installed correctly and receives adequate preventative maintenance it should give years of trouble-free service.

Abusive behaviour and accidental damage to the product are not covered by this guarantee.

The extent of this liability is limited to the cost of the replacement of the defective item and not to installation or consequential damages.

Materials

Component	Material
Body	Cast iron

Component	Material
Shaft	Stainless steel
Disc	Stainless steel
Bushes up to 100mm	PTFE
Bushes up to 125mm	Gunmetal
'O' ring	EPDM
Liner	Nitrile

[Flange Data](#)

Size	Code	Flange Diameter (mm)	Pitch Circle Diameter (mm)	No of Bolts	Bolt Diameter (mm)	Hole Diameter (mm)	Raised Face Diameter (mm)	Raised Face Height (mm)	Thickness of Flange (mm)
65mm	15332	160	130	4	M12	14	-	-	16
80mm	15333	190	150	4	M16	19	-	-	18
100mm	15334	210	170	4	M16	19	-	-	18
125mm	15335	240	200	8	M16	19	-	-	20
150mm	15336	265	225	8	M16	19	-	-	20
200mm	15337	320	280	8	M16	19	-	-	22

Pegler Yorkshire reserve the right to change specifications

[Technical Suitability](#)

Steam	Water	Oil	Air	Gas	Inert Gas	Combustible†	Gas Corrosive††	Gas Oxygen
no	yes	no	no	yes	yes	yes	yes	no

Pegler Yorkshire reserve the right to change specifications

Gas application guide

Class 1. INERT Air, argon, carbon dioxide, helium, nitrogen

Class 2. COMBUSTIBLE Hydrogen, methane, natural gas, town gas

Class 3. CORROSIVE Chlorine, sulphur dioxide Class 4. OXYGEN

Class 1. INERT Air, argon, carbon dioxide, helium, nitrogen

† Valves are suitable for British Gas Applications Family Gases 1, 2 and 3.

†† Suitable in applications where moisture is completely absent.

Flange connections

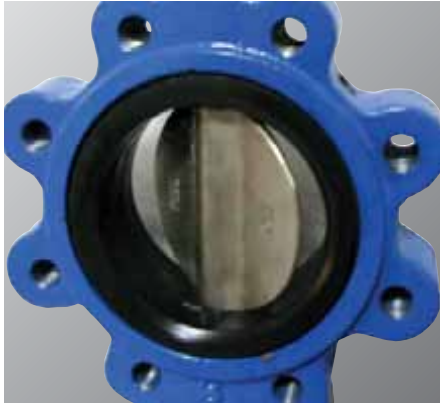

Flange components have their own design limitations and correct selection and compatibility is vital.

Flange material specification:

- *Pressure and temperature must not exceed its rating.*
- *Gasket selection must be in line with the rating of the flange.*
- *The fluid being handled will affect the gasket selection.*
- *All bolts must be compatible with the flange being used.*

Pipe and its mating flanges should be cleaned and made ready for assembly.

A clean and appropriate gasket should be selected for the flange type being used. Flat face and raised faces should not be mixed.

Piping should be properly supported with use of correctly sized hanging or securing brackets.

All pipes need to be aligned correctly to ensure that the valve integrity is maintained, avoiding twisting and distortion of the valve's structure and valve damage.

As the valve is assembled ensure that the bolts are placed and secured with nuts at hand tightness employing the crossover method of tightening to secure a sound joint.

Butterfly valves provide positive shut off in both flow directions. The disc profile is designed to give sealing properties at minimum torque. Raised seat profile provides positive flange seal.