

## KM590E KELOX - FB - Manifold

Forward and return beam with heating circuits 3/4 "Eurocone AG, with ventilation at the highest point and emptying, Distribution ends sealed, connections with molded union nut 1 "flat sealing, Distributor with 1 "male, for screwing in individual distributor bars without additional connecting fittings On the VL double-spindle valve - pre-settable, on the RL water volume meter (0.5-2.5 l / min) Brass, pore-free metallised, including labels for each heating circuit and sound-insulated plastic consoles

**ATTENTION WITHOUT KM220 Euro screw connection!**

**Specimen - Model with ball valve - Set drawn:**

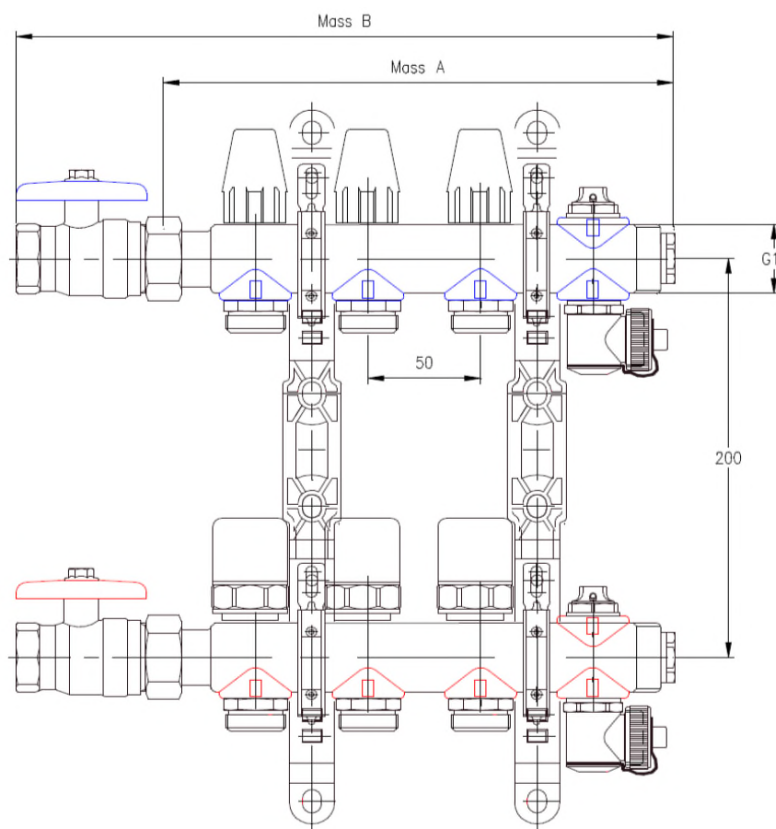

Heating Circuit Outlets	Total Pressure loss of manifold Q (l/h) / K <sub>VS</sub>	A	B With straight connector	B With ball valve set	B With corner ball valve (to centre main connection)	B WMZ-Set Horizontally	B WMZ-Set Perpendicular (To the centre main connection)
		mm	mm	mm	mm	mm	mm
2	430 / 1.36	176	196	242	271	476	271
3	660 / 2.09	226	246	292	321	526	321
4	820 / 2.59	276	296	342	371	576	371
5	1000 / 3.16	326	346	392	421	626	421
6	1200 / 3.79	376	396	442	471	696	471
7	1380 / 4.36	426	446	492	521	726	521
8	1480 / 4.68	476	496	542	571	796	571
9	1560 / 4.93	526	536	592	621	826	621
10	1680 / 5.31	576	596	642	671	896	671
11	1720 / 5.44	626	636	692	721	926	721
12	1840 / 5.82	676	696	742	771	996	771

*Total pressure loss:*

The measurement was performed with open valves and top meters and a pressurization of 0,1 bar.

*Medium:*

The built-in components are for heating water according to VDI2035 with 50% glycol content suitable. However, the modified viscosity must be taken into account.

## Technical Specifications

**Application:** T max. 80°C/6bar

### Flow media:

- Heating water
- Cooling water
- Water mixtures with common Corrosion and antifreeze additives

### Technical data for the flow meter - RL

Fluid temperature -10°C bis +80 °C  
Max. operating pressure 6 bar  
Kvs value at full opening - 0.8 m<sup>3</sup>/h  
Material: Heat resistant brass  
Plastics and stainless steel  
Gaskets made of EPDM  
Accuracy ±10% of final value  
(In the case of antifreeze mixtures, the modified viscosity)

### Service

The sight glass can be used for maintenance in case of need Dismantled and replaced. For this purpose the Corresponding heating circuit from the rest of the system. For this purpose, the valve in the leading bar and the Return air meter closed by complete screwing become. The sight glass can now be unscrewed (lower Water outlet possible) and can be easily replaced. Screw in the new sight glass manually and tighten.

### Technical data for thermostatic valve - VL

- kv - Value with thermostatic head at 2K control difference and
- kvs - Value at presetting and fully open valve

Closing dimension: 11,8 +/- 0,4mm; Lifting height: 2mm

Connection for thermal motor M30x1,5mm

### Thermostat valve m. default

Druckverlustdiagramm bei max.  
Geöffnetem Durchflussmengenmesser

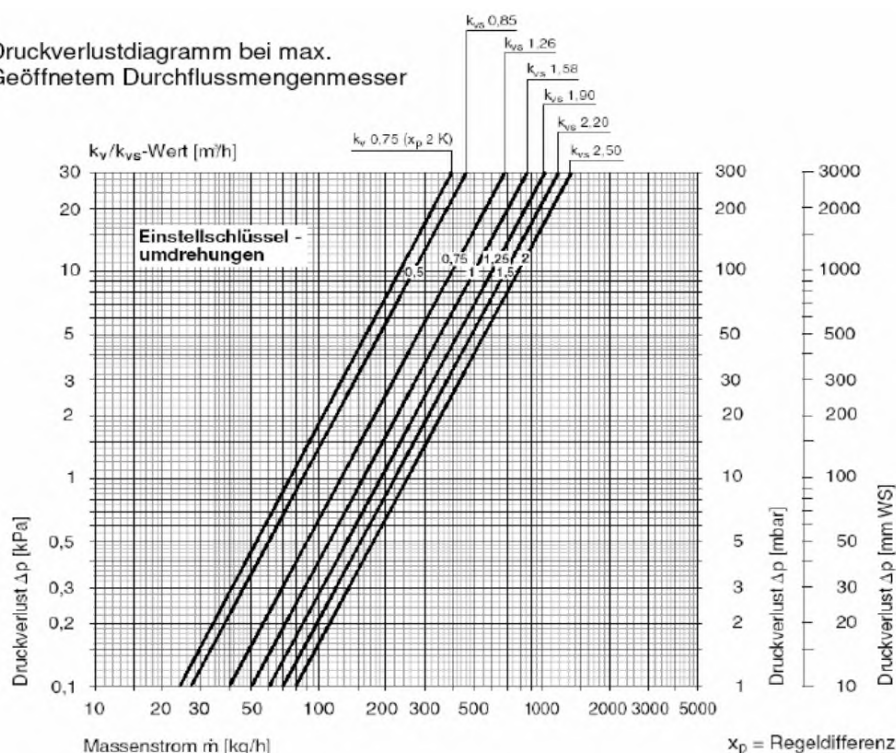

### Pressure loss diagram at max. valve opening

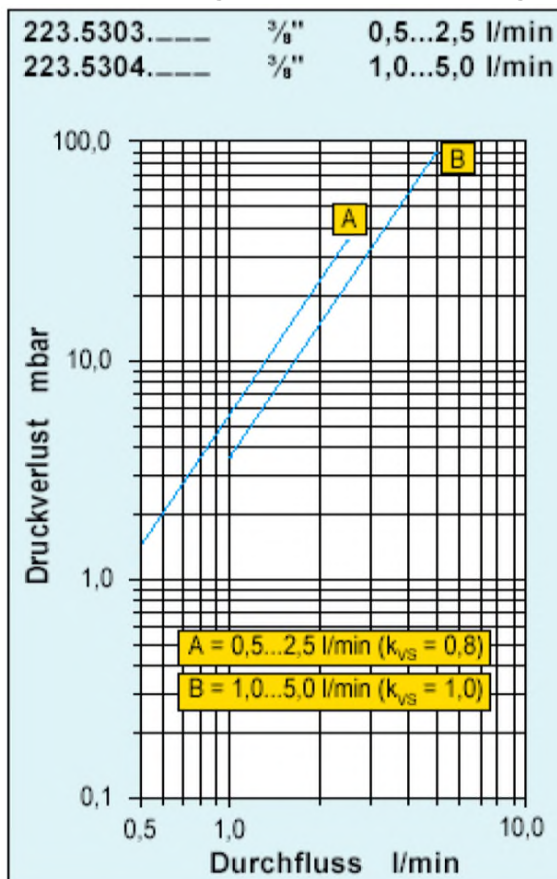

# Building Connection Set

KM593A Connection Set

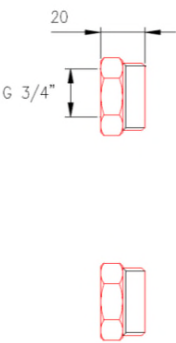

KM593E Connection ball valve

kvs-Value 21,5

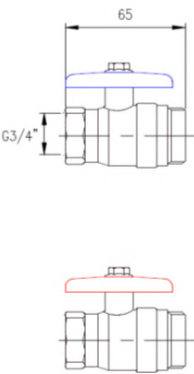

KM593E Connection ball valve

Winkel 90°

kvs-Value 10

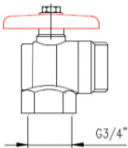
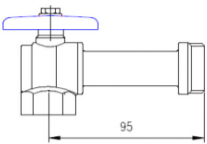

KM591E WMZ-Straigt Fitting

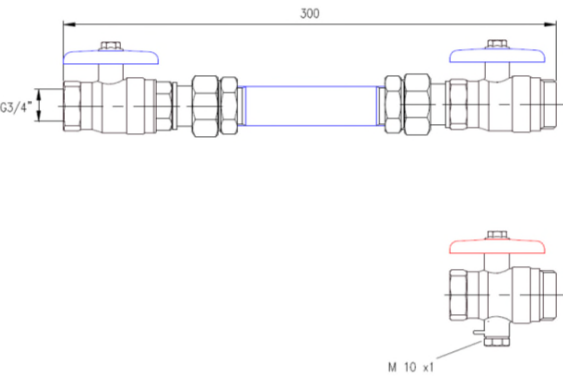

KM591E WMZ-Paßstück Winkel 90°

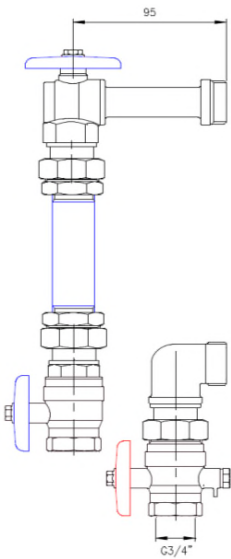

## KM 590E

Forward and return beam with heating circuits 3/4 "Eurocone AG, with ventilation at the highest point and emptying,  
Distribution ends sealed, connections with molded union nut 1 "flat sealing,  
Distributor with 1 "male, for screwing in individual distributor bars without additional connecting fittings  
On the VL double spindle valve - pre-settable, on the RL water level meter (0.5-2.5 l / min)  
Brass, pore-free metallised, including labels for each heating circuit and sound-insulated plastic consoles

**ATTENTION WITHOUT KM220 Euro screw connection!**

**Specimen - Model with ball valve - Set drawn:**

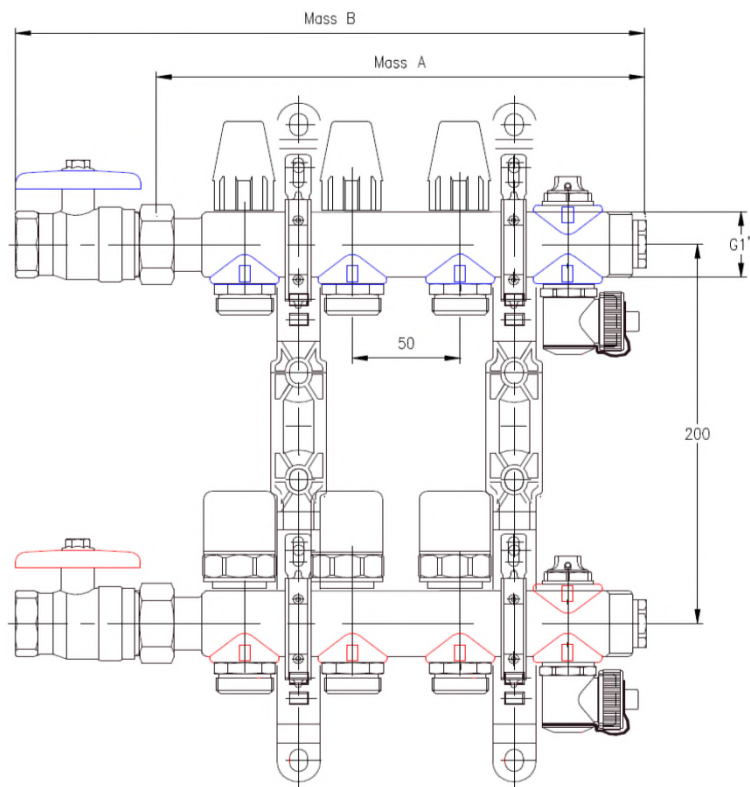

Heating circuit outlets	A	B Straight	B Ball valve Set	B Corner ball valve set (to centre of main connection)	B WMZ-Set Horizontal	B WMZ-Set Vertical (to centre of main connection)	B FWR-Set u. Eckk.-Set (to centre of main connection)
	mm	mm	mm	mm	mm	mm	mm
2	176	196	242	271	476	271	511
3	226	246	292	321	526	321	561
4	276	296	342	371	576	371	611
5	326	346	392	421	626	421	661
6	376	396	442	471	696	471	711
7	426	446	492	521	726	521	761
8	476	496	542	571	796	571	811
9	526	536	592	621	826	621	861
10	576	596	642	671	896	671	911
11	626	636	692	721	926	721	961
12	676	696	742	771	996	771	1011

### Internal

Type	Length (mm)
1 - 4	460
5 - 8	690
9 - 12	840
Sondergr.	1150