

ADEY®



MagnaCleanse®

Advanced Central Heating System Flushing

Assembly Guide

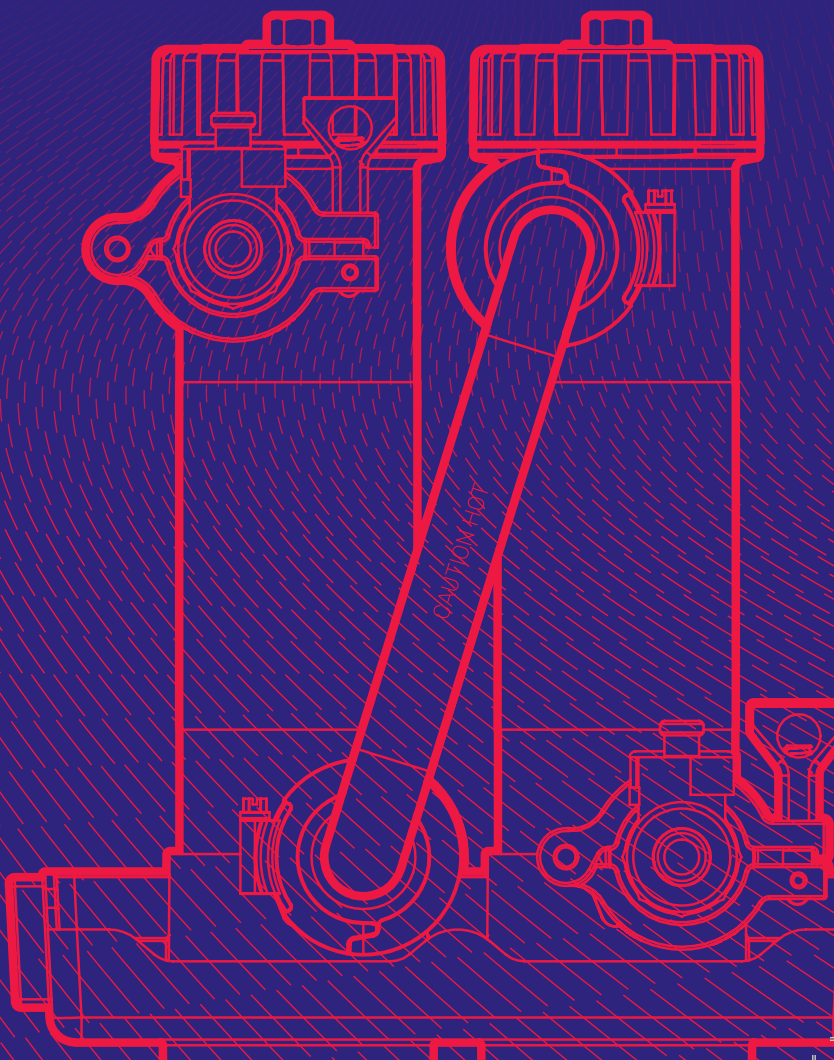

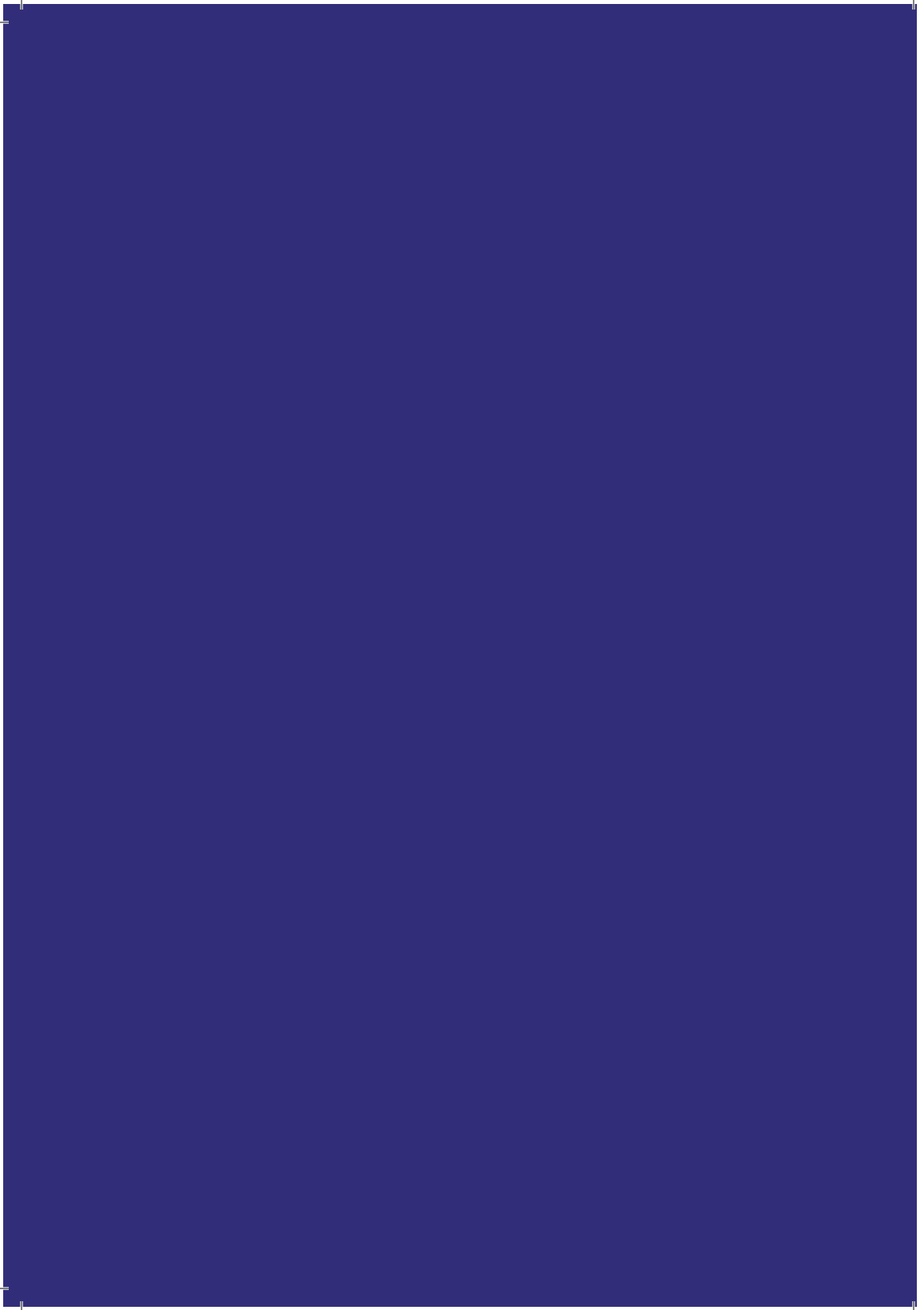

CAUTION:



Red protection caps fit onto the ends of the jubilee clips to protect the installer against the sharp edges.

THIS PRODUCT COMPLIES WITH CURRENT EU PRODUCT LEGISLATION

Contents

MaganCleanse system contents, including:

- *MagnaCleanse RapidFlush* filter
- *VibraClean*® radiator agitator
- *MagnaCleanse* adaptor kit
- *MagnaCleanse* hose-to-valve connector
- Hose lengths (x2)
- Hose clamps (x6)
- Female camlocks (x2)
- Tri-clamps (x2)
- Drain valve
- *MagnaClean*® Atom adaptor

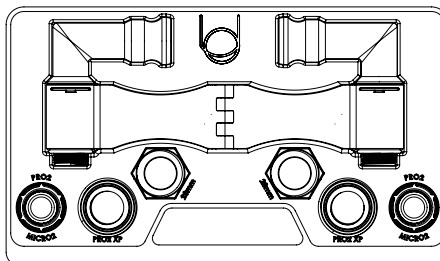

ADEY spares available from adeyspares.co.uk

MagnaCleanse Assembly

- 1 Unlock the catch by turning it to a horizontal position. Slide the lid off the case. Lift the canisters from the base and stand them up, slotting them into recessed area.

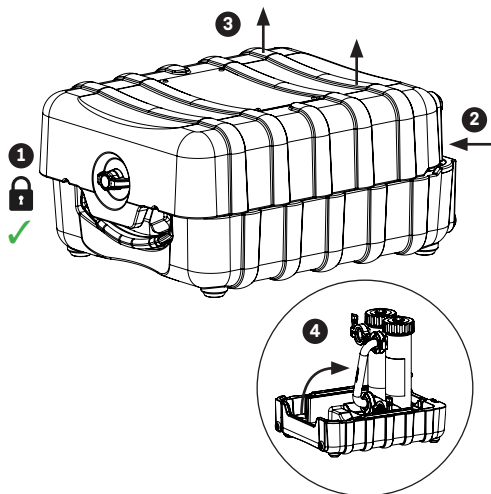

- 2 Cut one of the hoses 350mm from one end and install the drain point. Make sure it is secured with the jubilee clips provided. Always check ALL jubilee clips are tight when machine is in operation. Connect the two lengths of hose to either side of the drain valve, securing with jubilee clips (approx. a finger width from the connection).

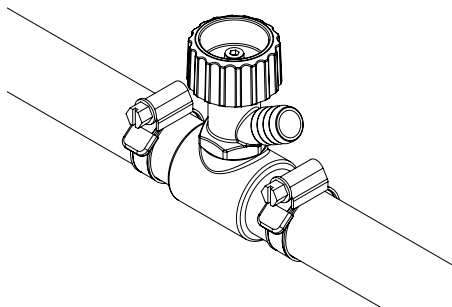

- 3 Remove the *RapidFlush* lever valve and tri-clamp fitting from the box. Add PTFE sealing tape to the thread before tightening. Ensure washer provided is fitted between tri-clamp and lever arm. Do not over-tighten. Attach to one end of the hose with the jubilee clip provided.

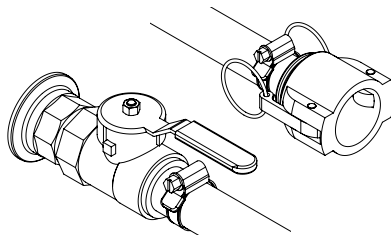

Fit no.2 cam lock to the other end of the hose with jubilee clips provided.

MagnaCleanse assembly continued

- 4** Attach blue seals to the inlets on the canister.

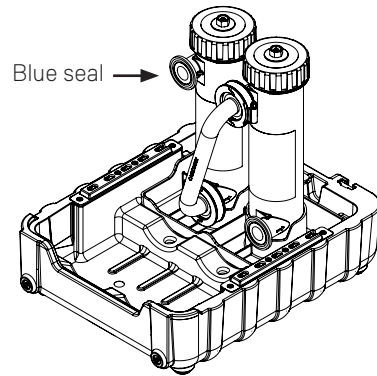

- 5** Attach the valves to the inlets on the *RapidFlush* filter. Fit tri-clamps over the pair of flanges, seal and tighten screw. Ensure the hose containing the drain off is attached to the bottom right inlet.

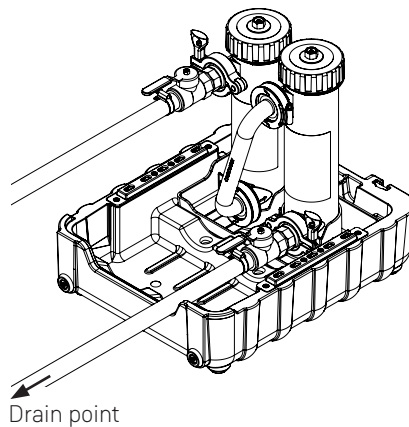

- 6** Your *RapidFlush* filter is now ready for use.

Packing *MagnaCleanse*

Take *MagnaCleanse* and hoses outside, being careful not to spill anything.

Dismantle, drain, clean and dry the system before replacing filters into the case.

Add plastic caps to keep the system dry. Ensure lid is fitted tightly and secured.

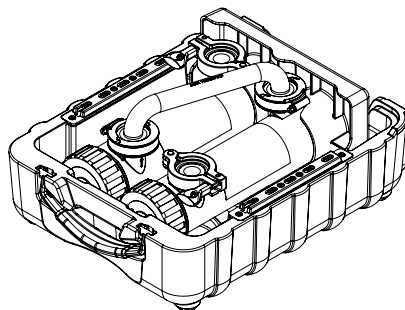



KE KELIT NZ Ltd.
0800 4 KE KELIT
0800 4 5353548
climatecontrol@kekelit.co.nz
www.kekelit.co.nz



For the most up-to-date version of installation and serving instructions visit www.adey.com

All ADEY marks are trademarks of Adey Holdings (2008) Limited. Please visit adey.com/trademarks for a list of ADEY marks.
Copyright Adey Holdings (2008) Limited © 2019. All rights reserved.