

Important:

The standard VDI 6036 recommends minimum demands of radiator brackets in different environments. To make these recommendations simple to understand for the user, there is a guideline in the withstanding tables. This is to give you the reliability and security in the planning and installation of the radiators.

Consider the wall material before the installation!

The minimum amount of brackets in the tables, is given under the circumstances. That they are used in wall material – lime stone or concrete – together with the screws and plugs that are delivered together with the brackets.

For other wall materials, like plaster, poroton or Ytong there has to be other types of screws and plugs and eventually more brackets per radiator.

From a general point of view, there has to be used the correct type of screws and plugs for the specific wall material in question. This can only be determined by the installer at the worksite.

More information regarding VDI 6036 guidelines, please look at our website.
www.sigarth.se

Minimum amount of brackets for AWK 1-3 to reach VDI 6036 in different wall materials

Wall material	Limestone / Beton			Poroton			
Height	300-400		500-954	300-400		500-954	
Classification							
Length	AWK 1-2	AWK 3	AWK 1-2-3	AWK 1-2	AWK 3	AWK 1-2	AWK 3
400	2	2	2	2	2	2	2
500	2	2	2	2	2	2	2
600	2	2	2	2	2	2	2
700	2	2	2	2	2	2	2
800	2	2	2	2	2	2	2
900	2	2	2	2	2	2	2
1000	2	2	2	2	2	2	2
1200	2	2	2	2	3	2	2
1400	2	3	2	3	3	2	3
1600	2	3	2	3	3	3	3
1800	3	3	3	3	3	3	3
2000	3	3	3	3	4	3	4
2200	3	4	3	4	4	3	4
2400	3	4	3	4	4	4	4
2600	3	4	3	4	5	4	5
2800	3	4	3	4	5	4	5
3000	3	4	3	4	5	4	5

Assembly instruction MCA-E/A 41/41 for mounting radiators without lugs

Panel radiator:
 Type 20 - 21 - 22
 300 - 954 mm
 Type 33
 400 - 954 mm



Extract from the VDI 6036 of the different fields of application (AWK):
 To simplify the understandings of the different applications, there is a distinction between installation in private and public houses.

Applications in private houses

AWK 1-2
 like
 Own homes
 Condominiums
 Rented flats
 Staff dining rooms
 Etc.

Applications in public houses

AWK 3
 like
 Railway stations
 Hotels
 Youth hostels
 Restaurants
 Hospitals
 Shopping centres
 Schools
 Etc.



SIGARTH AB
 Järnvägsgatan - SE 33033 Hillerstorp
 Tel. +46 (0)370 25400 www.sigarth.com

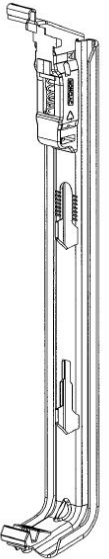

Wall distance

The distance from the wall to the backside of the radiator is 34 mm.

The measurement to the middle of the tube connection is given by the radiator producer.

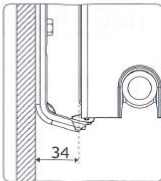

Anti slide

When 2 bracket are used according to the table, 2 anti slide parts should be used (1 right and 1 left side of the brackets)

When 3 or more bracket are used according to the table, 4 anti slide parts should be used (1 right and left of the outer brackets. And 2 anti slide parts on each side of the 3rd, 4th or 5th bracket).

The anti slide parts have a clamping function and will be pressed onto the welding seam.

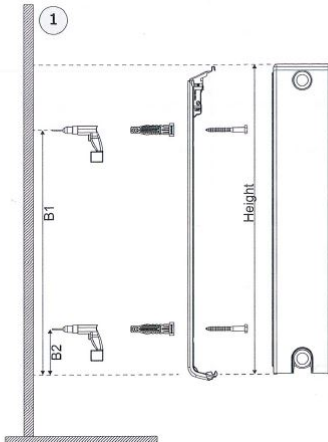
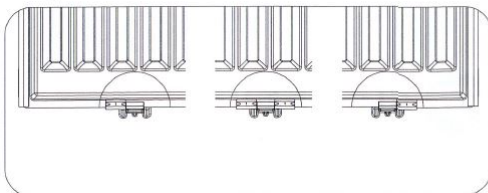

Drilling information:

- Plug 10 x 60
- Wood screw 8 x 75 mm
- Drilling 10 mm Ø
- Depth of hole 80mm
- Clean the hole

Remark:

Don't use hammer drills in lime stone material.

Dimensions in mm

Height	B1	B2
300	197	69
400	297	69
500	397	69
600	497	69
900	797	69

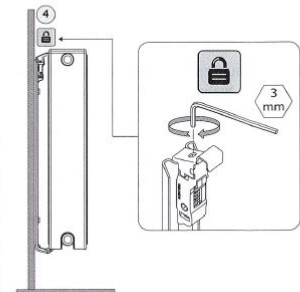
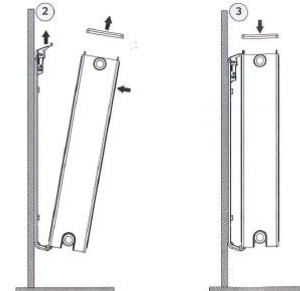

Note

After mounting, the upper part has to be secured by an allen key (3mm). This secures the radiator against lift-off.